

Period IV (1) – i. Documents showing the understanding of the Senkaku Islands by the U.S. Forces during the war

Document drawn up by the Office of Naval Intelligence during the war, which includes the Senkaku Islands as a part of the Ryukyu Islands
No.47 Office of Naval Intelligence 49, Change No.15, 600-Geography, Nansei Shoto May 1944

Overview

This document (Images1-3) is an excerpt of the sections concerning the geographical information of the Nansei Islands (Nansei Shoto), from among the complete collection of information (monograph) on the analysis of Japan's situation prepared by the U.S. Office of Naval Intelligence in May 1944 (*1). The document classifies the Ryukyu Islands into the respective regions A to F, and the Senkaku Islands (SENKAKU-GUNTO) are depicted as a part of section E – the Sakishima Islands (SAKISHIMA GUNTO) (Image 2: next page).

In addition to confirming that the Senkaku Islands are included as a part of the Ryukyu Islands, the document also presents the a detailed map of the Senkaku Islands (Uotsuri Island, Minamikojima Island, Kitakojima Island, and Kuba Island), showing for example that there is a place on Uotsuri Island where small boats can berth, and that there is a crater of an extinct volcano on Kuba Island (KOBISHO) (Image 3: next page).

*1 Collected (copied) by the Okinawa Prefectural Archives from the U.S. National Archives and Records Administration (NARA). Based on the classifications drawn up by NARA, the Okinawa Prefectural Archives categorizes this document as a part of the series of World War II Action and Operational Reports. In addition to the location of each island, various other forms of information necessary for carrying out military operations have also been accumulated, such as temperature, sea water temperature, sea surface density, tidal currents, tides, etc.

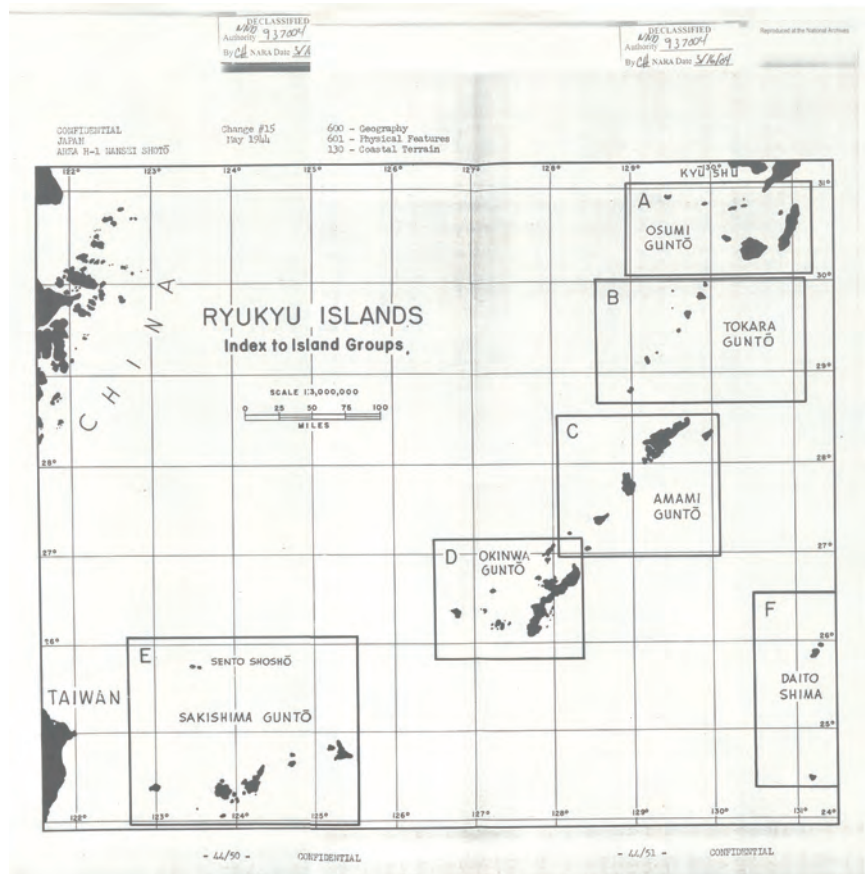

Repository: Okinawa Prefectural Library

Image1: E-SAKISHIMA GUNTO is shown as a part of the Ryukyu Islands (Note: For ease of presentation, the image, split between two pages, has been combined)

Date Created	May 1944
Author(s) & Editor(s)	U.S. Office of Naval Intelligence
Publisher	U.S. Office of Naval Intelligence
Name of Publication	(00010-001) ONI 49, Change No.15, 600-Geography, Japan Area H-1, Nansei Shoto (May 1944) (1/2)
Language	English
Medium	Paper
Public Access	Available to the public
Repository	Okinawa Prefectural Archives
Reference& Information	Follow the instruction at the Okinawa Prefectural Archives (Available at the website of the Okinawa Prefectural Archives)

Excerpt [English translation]

SENKAKU GUNTO (SENTO SHOSHO)	Summit of extinct volcano KOBISHO
Small boat landing with slip	Kita-ko-Shima Minami-ko Shima
UOTSURI SHIMA	

Image2: SENKAKU GUNTO (SENTO SHO-SHO) is depicted as a part of E - SAKISHIMA GUNTO
 *The actual location of the Senkaku Islands is to the north of the Yaeyama Islands.

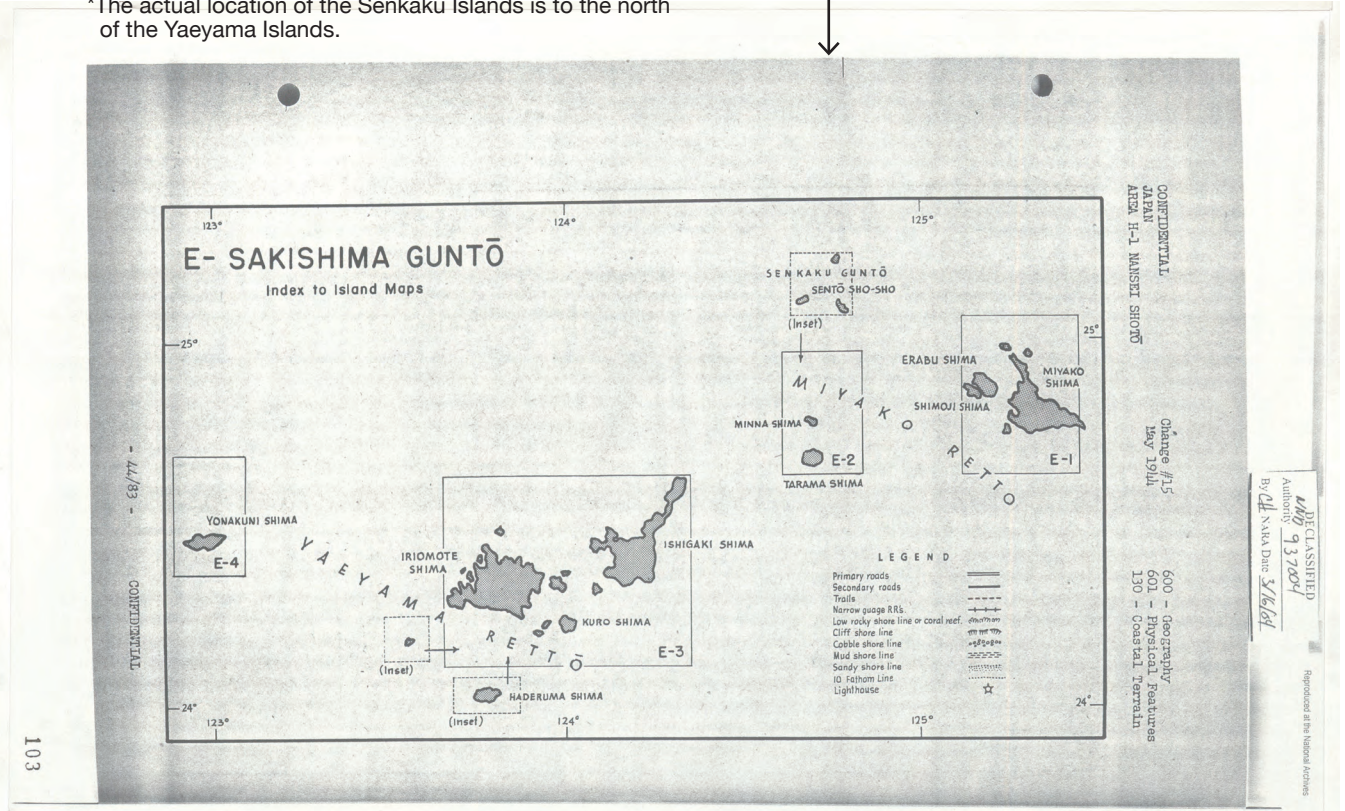

Repository: Okinawa Prefectural Archives

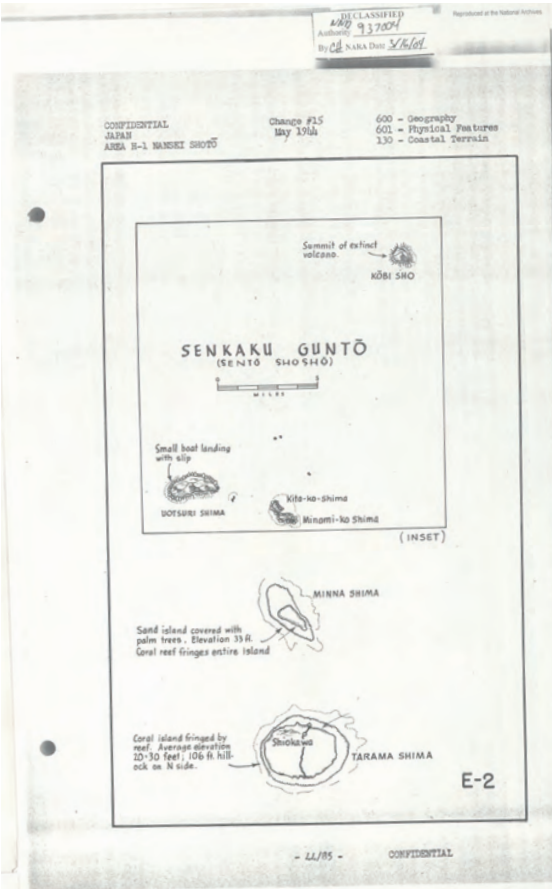

Enlargement of the Senkaku Islands of image3
 Repository: Okinawa Prefectural Archives

Image3: Uotsuri Island, Kitakojima Island, Minamikojima Island, and Kuba Island (KŌBI SHO) are depicted as a part of the Senkaku Islands (SENKAKU GUNTO). This image shows that there is a disembarkation point for small boats on Uotsuri Island, and a crater of an extinct volcano on Kuba Island.